

GENERAL NOTES

1. ALL PORTLAND CEMENT CONCRETE SHALL BE CLASS II.
2. TO THE EXTENT OF ANY INCONSISTENCIES BETWEEN THE DRAWINGS AND THE SPECIFICATIONS, THE SPECIFICATIONS SHALL CONTROL.
3. ALL CURBS SHALL BE 6.00 INCHES HIGH AND 6.00 INCHES WIDE.
4. ALL CURBS SHALL BE 6.00 INCHES HIGH AND 6.00 INCHES WIDE.

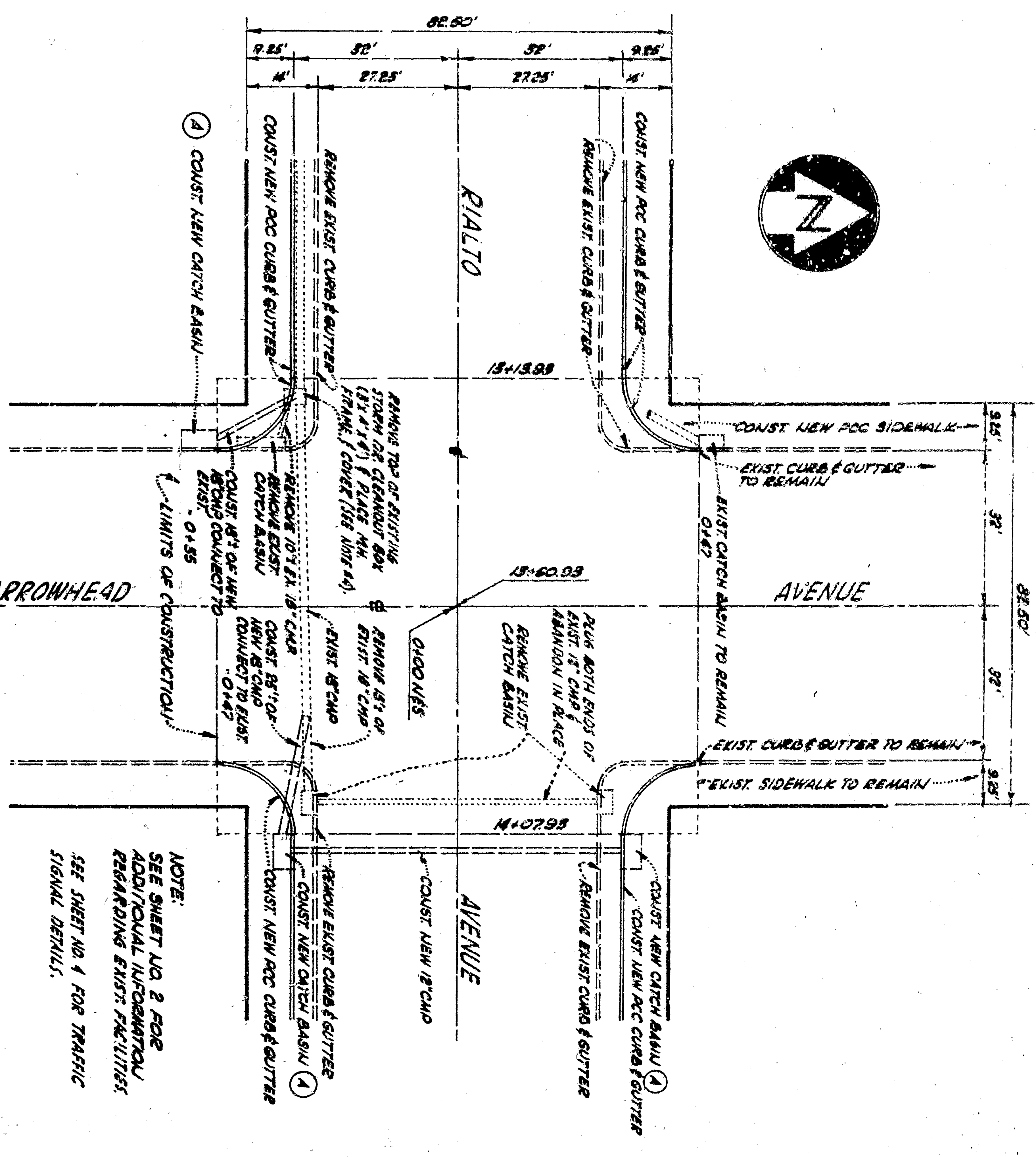
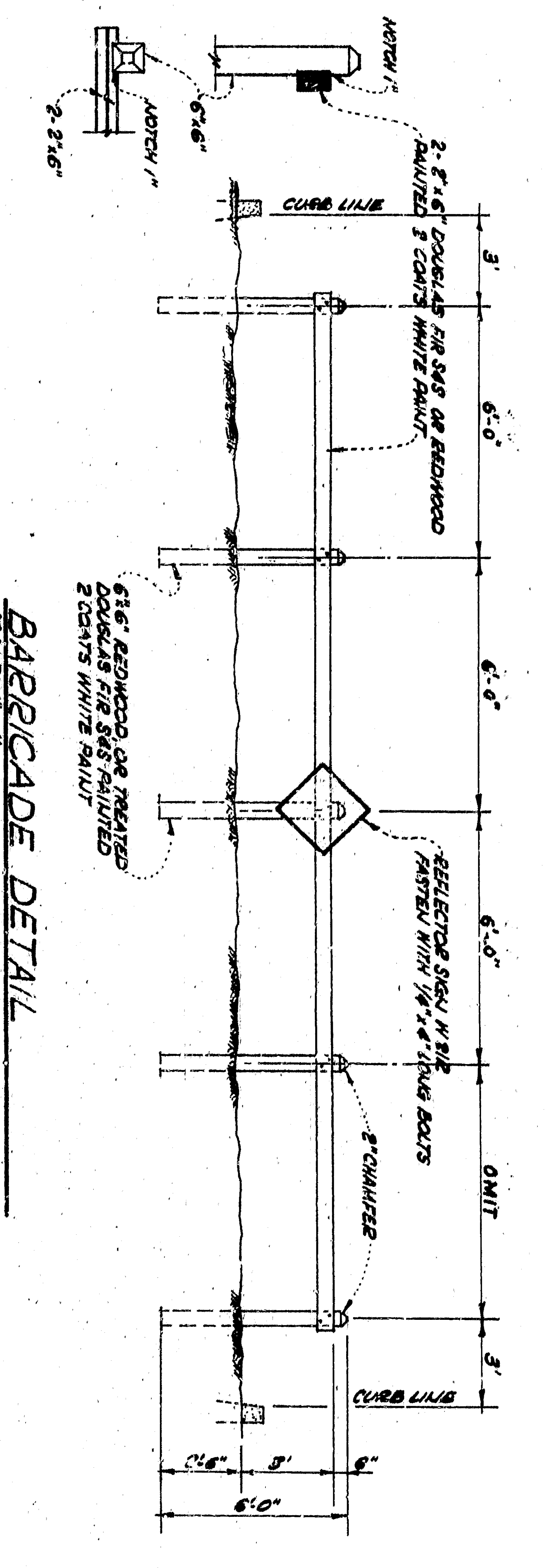
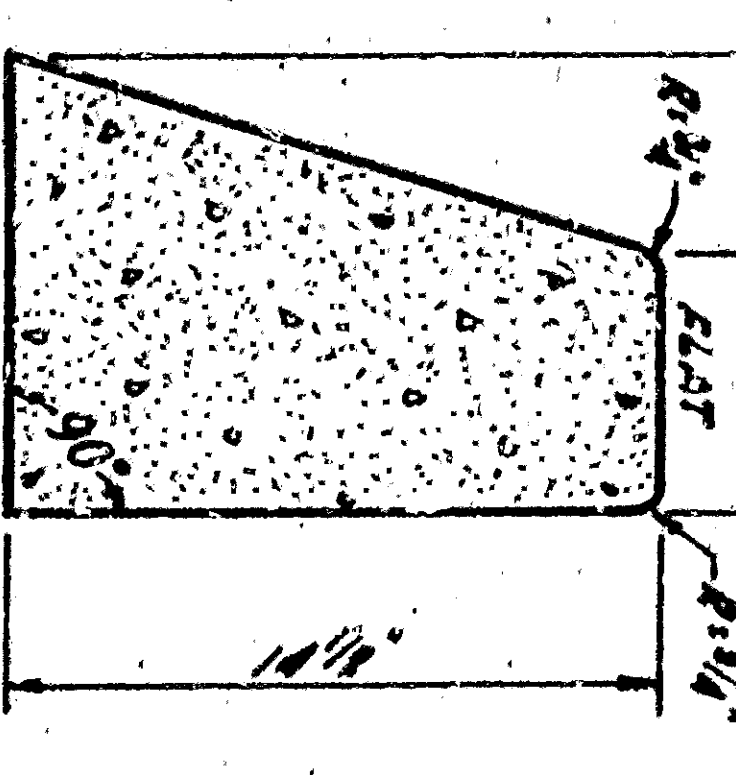
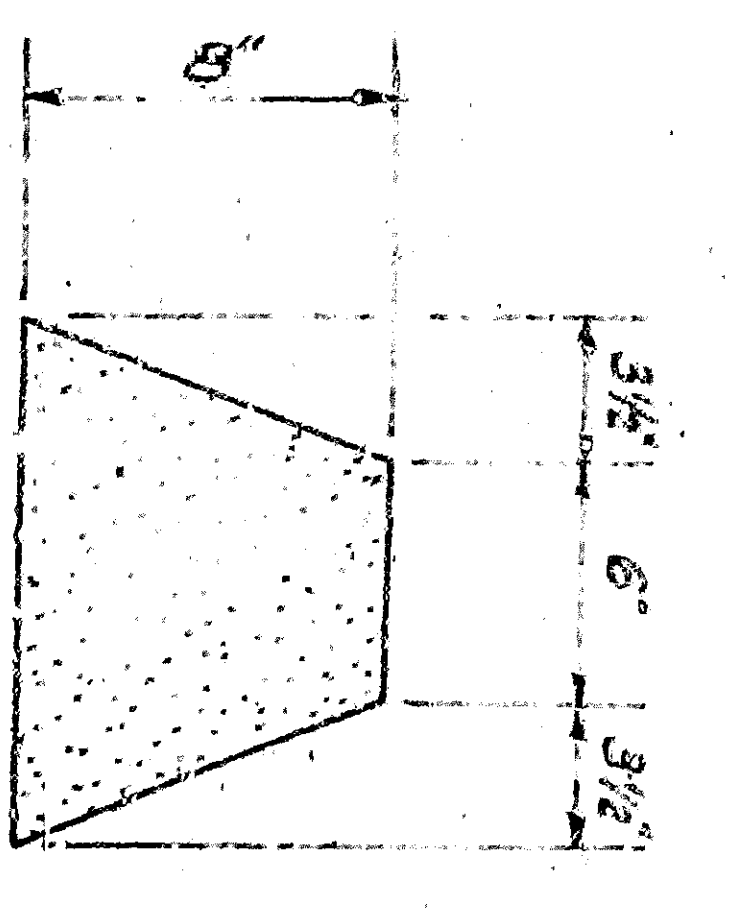
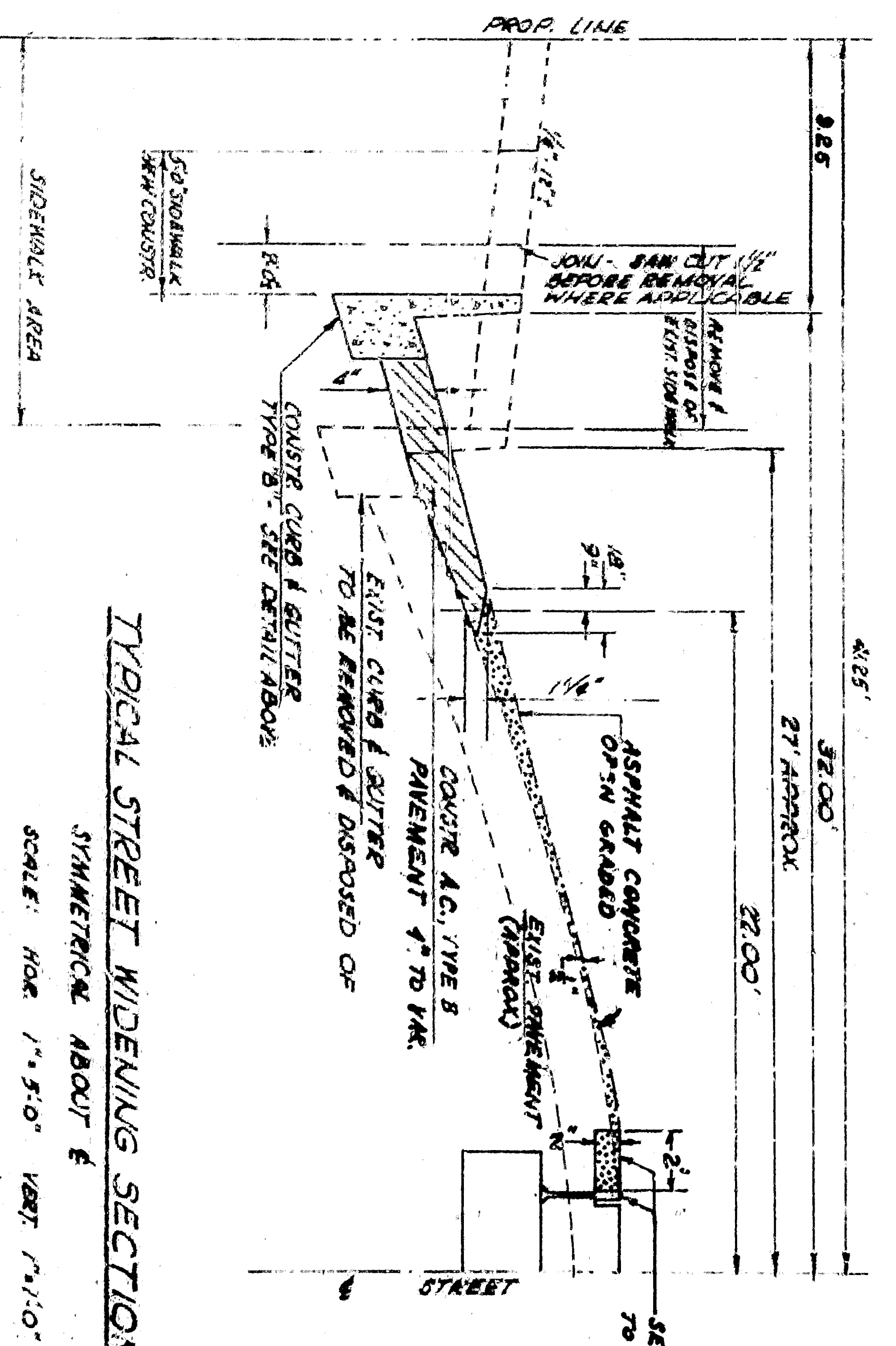
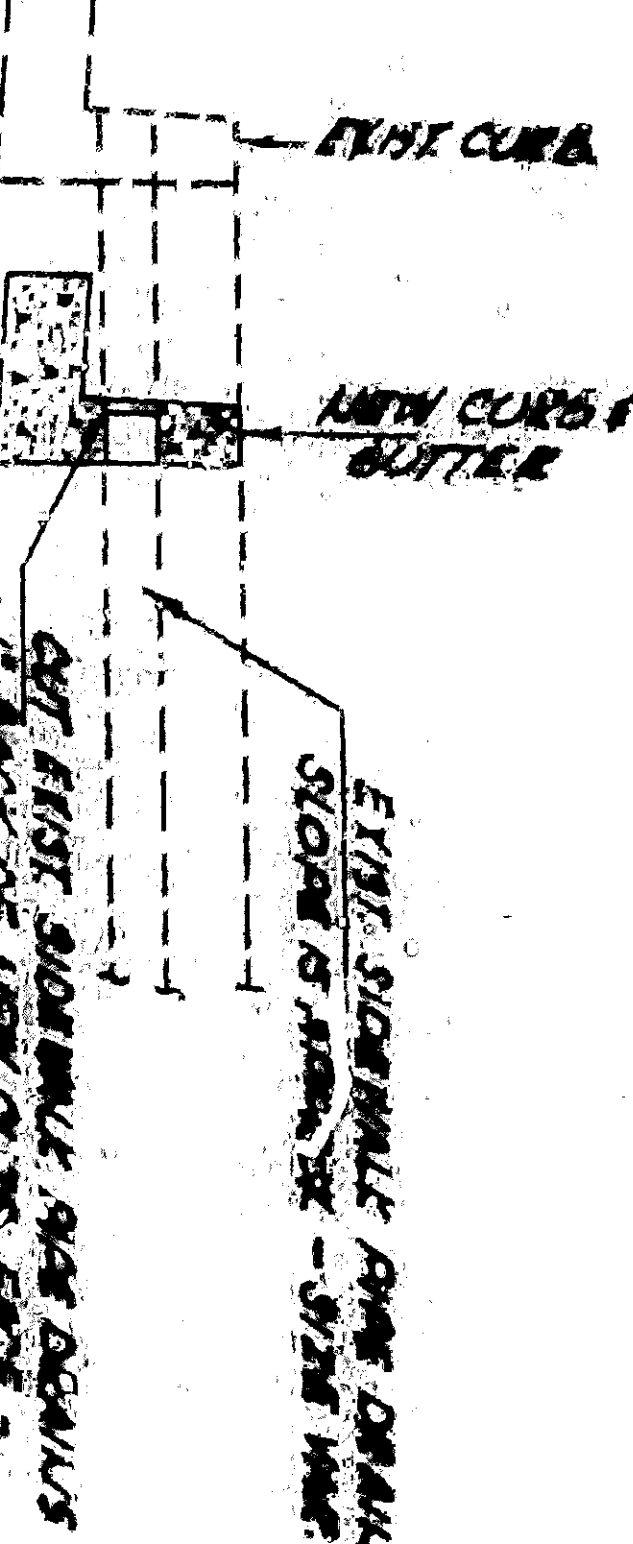

PLAN - INTERSECTION RIALTO & ARROWHEAD AVENUES

SCALE: 1/4\"/>

NOTE:  
SEE SHEET 10 & 11 FOR  
ADDITIONAL INFORMATION  
REGARDING EXISTING UTILITIES  
SEE SHEET 10 & 11 FOR TRAFFIC  
SIGNAL DETAILS.

NO. DATE	REVISIONS	BY
1	2-28-83	UPDATE PLANS SUB SIERRA VIL FOR STANDARD CATCH BASINS
2	3-15-83	REVISED FOR STANDARD CATCH BASINS

DESIGNED BY	APPROVED BY	DATE
STATE ENGINEER	STATE ENGINEER	1/15/83

PROJECT AREA NO.	PROJECT AREA NO.
CALE R-10	CALE R-10

DEPARTMENT OF ENGINEERING	DEPARTMENT OF ENGINEERING
CITY OF SAN BERNARDINO	CITY OF SAN BERNARDINO

REFERENCE	DATE
2875	1/15/83